

## VACUUM BREAKER VB 16

### DESCRIPTION

The VB16 vacuum breakers are simple and reliable devices that automatically relieve or “break” an unwanted vacuum condition, restoring the atmospheric pressure.

This device is particularly suitable for steam heated units of small and medium volume as heat exchangers, heating coils, calorifiers, jacketed kettles, steam boilers, etc.

Connections are male screwed.

**OPTIONS:** Stainless steel inlet deflector  
**USE:** Saturated steam and other gases compatible with the construction

**AVAILABLE MODELS:** VB16

**SIZES:** ½” to 1”

**CONNECTIONS:** Screwed ISO 7/1 RP (BS21)

**INSTALLATION:** Vertical installation  
 See IMI, installation and maintenance instructions.

**LIMITING CONDITIONS:** 12 bar at 150 °C  
 16 bar at 120 °C

How to order: i.e. VB16 DN ½” BSP (0,05-0,10bar)

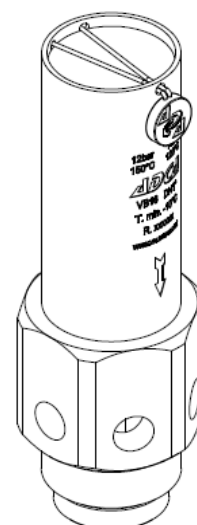
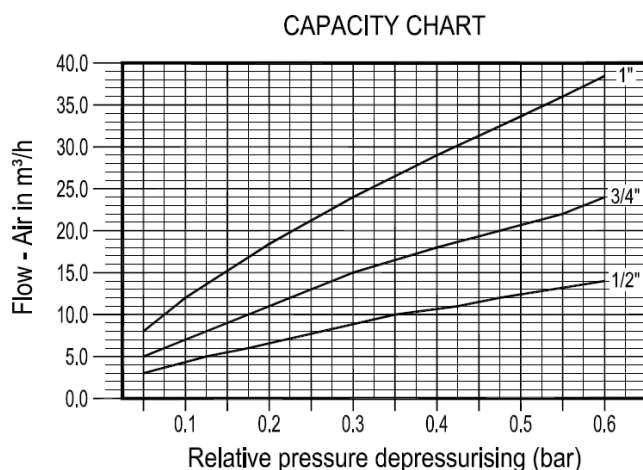

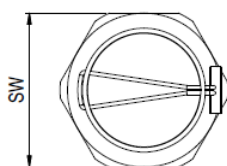
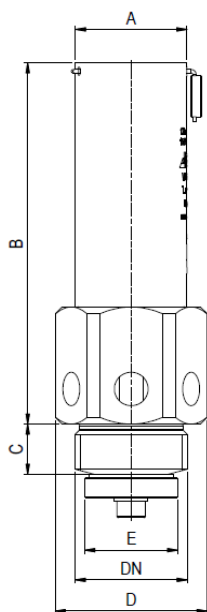

| DIMENSIONS (mm) |    |     |    |    |      |      |    |    |          |
|-----------------|----|-----|----|----|------|------|----|----|----------|
| SIZE DN         | A  | B   | C  | D  | E    | F    | G  | SW | WGT. Kgs |
| 1/2"            | 26 | 82  | 11 | 35 | 18   | 12,5 | 23 | 32 | 0,25     |
| 3/4"            | 33 | 85  | 13 | 39 | 21   | 16,5 | 28 | 36 | 0,34     |
| 1"              | 33 | 108 | 15 | 45 | 27,5 | 20   | 35 | 41 | 0,51     |

Set depressurising bar: (0,05-0,10), (0,09-0,20), (0,19-0,30), (0,29-0,40), (0,39-0,50).

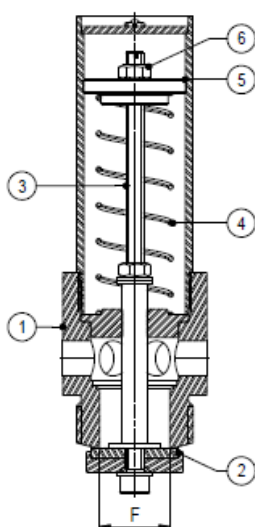

| MATERIALS |              |                            |
|-----------|--------------|----------------------------|
| POS.Nr.   | DESIGNATION  | MATERIAL                   |
| 1         | Body         | AISI316 / 1.4401           |
| 2         | *Valve       | AISI316 / 1.4401 and VITON |
| 3         | Stem         | AISI304 / 1.4301           |
| 4         | *Spring      | AISI302 / 1.4300           |
| 5         | Spring guide | AISI304 / 1.4301           |
| 6         | Nut          | A2-70                      |

\*Available spare parts.

### Typical Installation

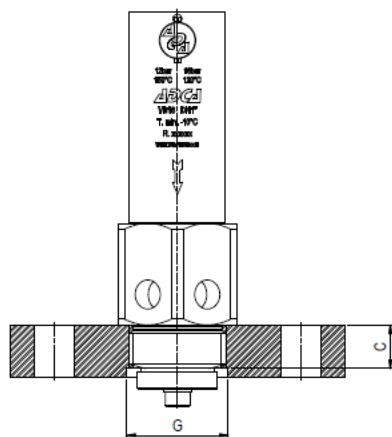

With flange

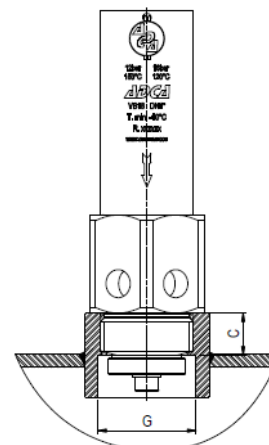

With socket